

REV. NO.	DESCRIPTION	REVISIONS	DATE

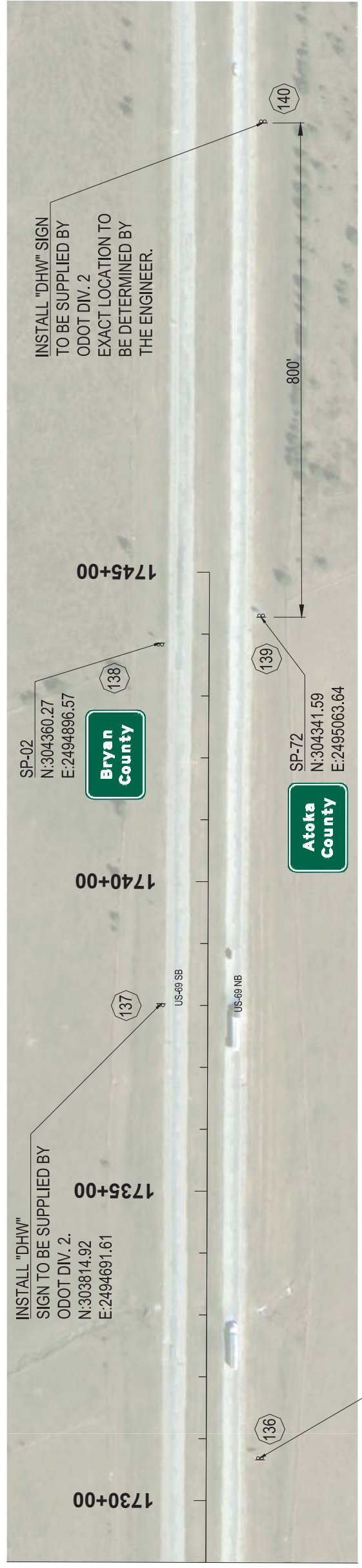

MATCHLINE - STA: 1729+00.00

INSTALL "DHW" SIGN  
TO BE SUPPLIED BY  
ODOT DIV. 2  
EXACT LOCATION TO  
BE DETERMINED BY  
THE ENGINEER.

1745+00

1740+00

1735+00

1730+00

US-69 SB

US-69 NB

800'

SP-02  
N:304360.27  
E:2494896.57

**Bryan  
County**

SP-72  
N:304341.59  
E:2495063.64

**Atoka  
County**

SP-71  
N:303071.78  
E:2494580.51

**Atoka  
McAlester  
Muskogee**  
19  
67  
135



1000 WEST WILSHIRE BLVD.  
SUITE 403-E  
OKLAHOMA CITY, OK 73116  
PHONE: (405) 384-5127

US - 69  
DIVISION 2  
BRYAN COUNTY

**SIGNING PLAN**  
STA: 1729+00 TO STA: 1745+00

State Job No. 33252(04) Sheet No. 41 OF 123